



THE COMMUNITY PLANNING & DESIGN
INITIATIVE AFRICA - CPDI AFRICA

AFRICAN HERITAGE ARCHITECTURE COMPETITION BRIEF

The Cultural Community Center

2021

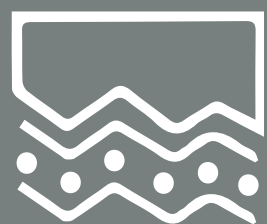
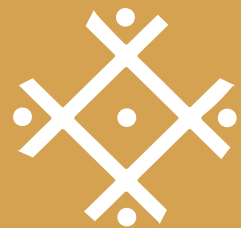
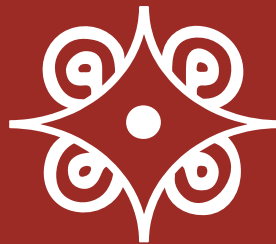

Introduction:

A Cultural Community Center inspired by African Origins

Have you ever imagined what the architecture of Africa would look like today, if the great civilizations of Egypt, Timbuktu, Mali, the Dogon, Zulu, Yoruba, and thousands of other African empires had continued to develop and evolve in their own unique identity? Imagine the transformation of the African landscape into sprawling metropolises filled with architectural masterpieces celebrating new interpretations of traditional design elements, portrayed with all the comfort of modern innovations and technique.

The Community Planning & Design Initiative Africa (CPDI Africa) 2021 culture-inspired, research-based design competition aims to promote the development of new architectural languages for the African Diaspora that are culturally and environmentally sustainable.

What Africa would you build if given the opportunity to develop African skylines in her own image?

The Challenge:

The CPDI Africa 2021 competition calls for design entries of prototypes for a **contemporary Cultural Community Center** inspired by architecture of the African Diaspora.

To design prototypes of African centered or inspired architecture that reflects the culture, aesthetics and sustainability for community design and development in today's Africa, research must accompany the design. The links between research and design are achieved in three categories:

- Culture-Lifestyle (floor plan & functionality)
- Aesthetics (finishing & furnishing)
- Sustainability (materials, climate & cost)
- Spirituality & Sacred Spaces
- Design Philosophy & Community Engagement

KENYA IC

Kenya Safari Lodge

Kenyan women in traditional dress, Kenyan women in traditional dress

The SALMA Morocco IC

Arab Architecture, Morocco, Arab architecture

SOUTH AFRICA

Detached house, in Stellenbosch Heights, Stellenbosch, Cape Town, Western Cape, South Africa

The Basotho Hut, Lesotho, Basotho ethnic group, South Africa

The BUSIKU Zambia IC

Museum in Choma, Lusaka/Lusaka Road, Tonga Hill

Makombo Safari Lodge, Kafue National Park, Zambia

- <https://cpdiafrica.com/architects-to-follow/>
- <https://digitalcommons.kennesaw.edu/atl/>
- <https://cpdiafrica.blogspot.com/>
- <https://www.cpdiafrica.org/>

Participants must also understand the use of particular materials and building techniques, paying special attention to sustainability, availability and affordability of local materials in their selected African region. It is critical to utilize such materials and techniques in a way that proves their relevance in a contemporary built environment for Africa.

Participants are encouraged to acquire additional inspiration from the evolution of other African arts, such as music, fashion, visual arts, cuisine, film and theater, for more intricate expressions of African creativity, but most importantly how African life is lived. It is the architectural translation of these elements of daily life that will strengthen your design concept.

Finally, participants must harmonize their research findings to develop their designs according to the CPDI Africa 2021 design brief. Through this process, collaborating architects, artists, designers and allied built environment professionals will create stimulating and successful design prototypes for a culturally appropriate and sustainable Cultural Community Center for Africa and the Diaspora.



Design Guidelines:

Participants of the CPDI Africa design competition must Create a design concept for the Cultural Community Center that:

1. Is unique and iconic, preserving the architectural heritage of the culture
2. Draws functional inspiration from 1 (one) specific Ethnic Group or Region in Africa
3. Occupies a minimum built-up area of 600m²
4. Occupies a culturally appropriate context that is reflective of the functionality of urban African spaces
5. Utilizes a spatial program that elaborates on the building's use as a museum & cultural center
6. Reflects elements of African culture, lifestyle and philosophy in its functionality
7. Celebrates the African identity in its interior design, aesthetics and visual imagery
8. Is built with materials that are locally available, sustainable and affordable
9. Is realistic, buildable and can be replicated easily by both skilled and unskilled labourers
10. Can be constructed successfully given issues of cost, materiality and regional economic factors

Culture-Lifestyle (floor plan & functionality):

- The spatial organization should support contemporary African lifestyles and should cater to the needs of diverse groups in an African Urban setting while upholding the values of accessibility and universal design.
- Participants are expected to have a variety of functional spaces that include but are not limited to a multipurpose hall, exhibition space/gallery, library, workshops/classes, cafeteria, retail space, meeting rooms and administrative spaces.
- Participants are encouraged to be creative in proposing additional spaces for specialized activities that would make their Cultural Center unique and serve as the main attraction to potential users.





Design Guidelines:

Aesthetics (finishing & furnishing):

- The building's aesthetics should maintain visual relationships between the building's typology as a cultural center and its exterior form and interior finishes.
- Participants should integrate the environmental, cultural and functional requirements of the building with the users' experience of both the Cultural Center's interior and exterior spaces.
- Participants are encouraged to utilize material finishes in combination with moveable and fixed furniture to promote comfort, address noise, privacy, access and circulation considerations, as well as cater to rich cultural experiences.

Sustainability (materials, climate & cost):

- Based on the typically hot and dry or humid climate of the participants' selected region, the Cultural Center should utilize passive design strategies and consider key elements like orientation, daylighting, ventilation, heating and cooling.
- Construction materials specified for the building should fulfill functional, structural and aesthetic requirements in an innovative manner without rendering significant harm to the environment.
- Materials used in the building should also be sourced from the local region and contribute to the local economy.

Spirituality & Sacred Spaces:

- Participants should represent spirituality in their designs by proposing spaces in their Cultural Center that celebrate the multiple faiths, traditions, events and cultures present in their chosen African region or ethnic region.

Design Philosophy & Community engagement

- The Cultural Center should promote inclusivity and community activities that empower members of the participants' selected ethnic group/African region.



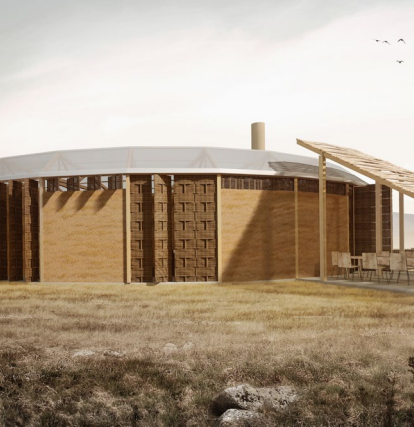

Submission Requirements:

1. A submission poster (JPEG/png file format) which can be downloaded from [your account](#) on the CPDI Africa Website.
2. A link (google drive/dropbox) to the participants' submission folder with the title format *Participant's name_Prototype name_CPDI 2021* to be provided in the submission portal. Each folder should contain the following files:
 - a. Inspirational & Conceptual Narrative - A 1500 word narrative submitted in Word format that covers:
 - A female/feminine name for the Cultural Center chosen from the primary ethnic group/region that inspired its design (plus the meaning of the name).
 - The unique features of the design and how it reflects the African design elements researched.
 - Details of the ethnic group or African region, traditional aesthetics and cultural activities that inspired the design.
 - Images of the motifs or patterns used in the design alongside their names and meanings.
 - Specifications for building materials used in structural elements, interior finishes and fenestrations.

It should also answer the following questions:

- *How are traditional architecture elements translated into contemporary architecture, through design elements of your Cultural Center?*
- *How does the design address issues of heat, cooling, ventilation and airflow?*
- *What are the reasons a prospective developer would choose to buy this design?*
- *Which of the unique features of the design are worthy of becoming a building code requirement for construction in Africa?*
- *What built environment challenges could be resolved through the use of indigenous science and technology in constructing the Cultural Center?*
- *How does the building promote the participation of women's guilds, youth, students, artisans and professional bodies in its construction, finishing, maintenance and daily operations?*



Submission Requirements:

- b. Floor plans, elevations and sections (JPEG format):
 - Represented in schematic form only (construction/working drawings are not required) with properly labelled spaces (name & size in sqm/square meters).
- c. 3D renders (JPEG format):
 - Minimum of two (2) 3D perspectives of the building (exterior and/or interior) with no text or labels.
 - Renders may be articulated with landscaping or waterbodies but should be devoid of vehicles, people or animals.
- d. Waiver acknowledgements:
 - Submitting your design and supplemental information to the competition serves as an automatic waiver. However, a populated official waiver form must also be filled that serves as evidence of participant'(s) agreement with the terms and conditions of this design competition.

Submission Deadline:

The submission portal opens: **May 1st, 2021**
and closes **August 31st, 2021**

Jury:

The jury panel consists of professional architects, designers and professors of Afrocentric architecture & design. The competition entries will be evaluated based on the following criteria:

- Design originality
- Design innovation
- Cultural appropriateness
- Contextual relevance
- Architectural preservation
- Community participation
- Form and function
- Impact & sustainability (Environmental, Social, Economic)



Awards & Honors:

Award categories include:

- Six regional winners (West Africa, East, Central, North, Southern Africa, and the Diaspora)
- Five Honorable Mentions per region

Benefits:

- Winners earn paid internships with CPDI Africa & Associates
- Promote your favorite African architecture to the world
- Become an ambassador in your country for CPDI Africa initiatives
- Showcase your resume and design portfolio internationally
- Feature in CPDI Africa Heritage Compendium & Exhibitions

Alongside award certificates, winners and honorable mentions will be featured on the CPDI Africa website and social media platforms and will also be invited to virtually present their designs to the jurors during the award ceremony.

Winners will also gain a free placement in any CPDI Africa Global Studio certified short course of their choice. Winners and honourable mentions will be the face of CPDI Africa in their respective regions/countries.

Looking forward to your amazing masterpieces.

 www.cpdiafrica.org



All images courtesy of CPDI Africa Architects & Designers

 design@cpdiafrica.org

 cpdiafrica.blogspot.com

 CPDI Africa Global Studio

 @cpdiafrica

 @cpdi_africa

 @cpdi_africa

 @cpdi_africa

 CPDI Africa

